

199907020618



199907020618

07/02/1999 02:25 PM Snohomish
P.0023 RECORDED County

INTERLOCAL AGREEMENT BETWEEN SNOHOMISH COUNTY AND THE CITY OF MARYSVILLE ON RECIPROCAL MITIGATION OF TRANSPORTATION IMPACTS

I. PARTIES AND CITATIONS

This Interlocal Agreement (hereinafter "AGREEMENT") is entered into pursuant to Chapter 36 70A RCW (the Growth Management Act), Chapter 43 21C RCW (SEPA), Chapter 36 70B RCW (Local Project Review), Chapter 58 17 RCW (Subdivisions), Chapter 82 02 RCW (Excise Taxes), Chapter 36 115 (Service Agreements) and Chapter 39 34 RCW (the Interlocal Cooperation Act) by the City of Marysville, a Washington municipal corporation (hereinafter "CITY") and Snohomish County, a political subdivision of the State of Washington (hereinafter "COUNTY")

II. PURPOSE AND RECITALS

- A This AGREEMENT between the CITY and the COUNTY relates to the policies and procedures for reciprocal review and mitigation of interjurisdictional transportation system impacts of land development
- B Within their own jurisdictions, the COUNTY and the CITY each have responsibility and authority derived from the Washington State Constitution, State laws, and any local charter to plan for and regulate uses of land and resultant environmental impacts, and by law must consider the impacts of governmental actions on adjacent jurisdictions
- C The CITY and the COUNTY recognize that planning and land use decisions can have extra-jurisdictional impacts and that intergovernmental cooperation is an

effective manner to deal with impacts and opportunities which transcend local jurisdictional boundaries

D The CITY and COUNTY have entered into a generalized, framework interlocal agreement for annexation within the Urban Growth Area (UGA) which includes general statements of principle and policy. This AGREEMENT addresses joint transportation system planning and impact mitigation consistent with the framework interlocal agreement.

E The CITY has taken numerous actions to address mitigation of environmental and other impacts generated by development proposals. The regulations, plans, codes, and mitigation policies designated in Section V below shall be collectively referred to as the CITY's mitigation policies. Among the CITY's mitigation policies is Marysville Municipal Code (MMC) 18.24 and 19.22, which provide the regulatory authority under which the CITY conditions land-use approvals to require developments in the CITY to mitigate their transportation impacts on COUNTY roads or the streets of other cities.

F The COUNTY has also taken numerous actions to address mitigation of environmental and transportation impacts generated by development proposals. The regulations, plans, codes, and mitigation policies designated in Section VI below shall be collectively referred to as the COUNTY's mitigation policies. Among the COUNTY's mitigation policies is Snohomish County Code Title 26B, including SCC 26B 55.080, which provides the regulatory authority under which the COUNTY conditions land-use approvals to require developments in the unincorporated COUNTY to mitigate their transportation impacts on city streets or other counties' roads.

G It is in the best interest of the citizens of both jurisdictions to initiate through interlocal agreement the reciprocal imposition of mitigation requirements and improvements.

III. MITIGATION FOR IMPACTS IN THE CITY BY DEVELOPMENTS IN THE UNINCORPORATED COUNTY

A Transportation Service Areas (TSAs) and the City Street System. For purposes of this AGREEMENT and implementing the provisions of Title 26B SCC, it has been determined that the CITY is located in TSA A as shown on the TSA Map in the Snohomish County Transportation Needs Report referenced in Section VI. Pursuant to this AGREEMENT the CITY shall determine the transportation impacts of COUNTY developments in TSA A on the CITY street system including State highways within the CITY.

199907020618

B Role of Chapter 43 21C RCW (SEPA) For most COUNTY developments, compliance with this AGREEMENT will satisfy the requirements to mitigate adverse and significant adverse impacts under Chapter 43 21C RCW (SEPA) for impacts on CITY streets However, consistent with SCC 26B 50 030, this AGREEMENT does not limit the ability of the CITY to request additional mitigation pursuant to Chapter 43 21C RCW (SEPA) where the specific impacts of the development are not addressed by this AGREEMENT or for developments outside of TSA A

C Applicability to COUNTY Developments This AGREEMENT applies to all developments located in unincorporated Snohomish County and inside TSA A which are not exempt from the requirements of SEPA, and which have submitted a complete application, as determined by Snohomish County Planning and Development Services (SnoCoPDS) on or after the effective date of this AGREEMENT For the purpose of this AGREEMENT, developments meeting these conditions will be referred to hereinafter as "COUNTY DEVELOPMENTS"

D Providing Notice SnoCoPDS shall give the CITY agency notice and afford the CITY a timely opportunity for review, comment, staff consultation, and, where applicable, participation in the COUNTY's development review and approval process, related to the impacts that COUNTY DEVELOPMENTS may have on the CITY's transportation system under the CITY's designated mitigation policies

1 For all COUNTY DEVELOPMENTS, SnoCoPDS shall provide a notice of application to the CITY in accordance with the requirements of Chapter 32 50 SCC for other agencies with jurisdiction, even for developments not subject to the provisions of Chapter 32 50 SCC Notice shall be accompanied by a traffic study when determined necessary in accordance with Section III(E)

2 In addition, notice to the CITY shall be provided in a form and manner pursuant to the State Environmental Policy Act (SEPA), Chapter 43 21C RCW, for agencies with jurisdiction

E Traffic Study The COUNTY, through this AGREEMENT, shall require a traffic study from any COUNTY DEVELOPMENT that may have impacts on the CITY's transportation system requiring mitigation in accordance with this AGREEMENT Any such COUNTY DEVELOPMENT shall submit the requested traffic study to SnoCoPDS as part of its initial development application

- 1 The criteria for preparation of the traffic study shall be provided by the CITY and shall be consistent with Exhibit 3 for traffic studies to determine proportionate share impact mitigation
- 2 The COUNTY may waive the requirement for all or part of the traffic study if the CITY indicates that all information necessary to assess the impact of the development is available
- 3 The Snohomish County Department of Public Works (SnoCoDPW) shall inform applicants, at the presubmittal conference, of the CITY's requirements for traffic studies and mitigation
- 4 Following review of the traffic study, the CITY may request supplemental information and analysis as necessary to determine the impacts of the development in accordance with this AGREEMENT. The COUNTY shall require the proposed development to submit the supplemental information and analysis to the extent that the COUNTY determines that it is necessary to determine the impacts of the development in accordance with this AGREEMENT.

F Mitigating Measures If it is determined by the CITY that a COUNTY DEVELOPMENT will impact the CITY's transportation system, the CITY shall notify the COUNTY of specific measures reasonably necessary to mitigate said impacts in accordance with the CITY's designated mitigation policies referenced in Section V. For each mitigating measure requested the CITY shall identify the specific impact and reference the relevant CITY mitigation policy. Notification of the specific mitigating measures shall be provided by the CITY within twenty-one (21) days of the date of notice of application provided in accordance with Section III(D) except where notice is for review of an environmental impact statement, in which case the review period shall be as established in accordance with WAC 197-11-502.

If SnoCoPDS does not receive the CITY's notification of mitigating measures consistent with Section III(F) above, SnoCoPDS may assume that the CITY has no comments or information relating to potential impacts of the development on CITY facilities and may not require any mitigation from the development for impacts on CITY facilities. The provisions of this section do not apply if SnoCoPDS fails to provide the CITY with notice of the development consistent with Section III(D) above.

G Scope of Mitigating measures Under this AGREEMENT, COUNTY DEVELOPMENTS may be required to mitigate impacts on CITY streets for any

of the following capacity (proportionate share impact mitigation), safety, access and circulation, or level of service Any COUNTY development may be required to meet any adopted minimum countywide urban growth area (UGA) standards for on-site transportation facilities (e g , roads, sidewalks, planting strips, etc) Any COUNTY development which fronts on the right-of-way of the CITY may also be required to provide frontage improvements, dedicate or deed right-of-way, and meet access-point requirements consistent with CITY standards, as adopted in Section V of this AGREEMENT

H Proportionate Share Impact Mitigation for COUNTY DEVELOPMENTS The CITY may request that a COUNTY DEVELOPMENT contribute a proportionate share of programmed capacity improvements to mitigate capacity impacts on CITY intersections and/or street segments There are two options for determining a COUNTY DEVELOPMENT's proportionate share impact mitigation as follows

- 1 The CITY has adopted a list of capacity improvements on CITY streets which is contained in its Comprehensive Plan The improvements are needed to support growth in the CITY consistent with the CITY GMA comprehensive plan Based on a comprehensive traffic study, a development's proportionate share impact mitigation may be calculated by determining the development's impact on these planned improvements and may be satisfied by payment in lieu of construction In determining the proportionate share payment under this option, the traffic study must meet the requirements shown in Exhibit 3
- 2 Alternatively, a COUNTY DEVELOPMENT may choose to have its proportionate share obligation based on an amount determined by the COUNTY and the CITY to fairly represent the average impacts of COUNTY DEVELOPMENTS on the capacity of CITY facilities for different subareas within the TSA A as described in Exhibit 1 Any development may satisfy its obligations under this section to contribute a proportionate share of CITY capacity improvements, by making a voluntarily-offered payment in lieu of construction equal to the percentage determined for the appropriate subarea as shown in the table in Exhibit 1, multiplied by the development's newly-generated peak hour trips, multiplied by the CITY's capacity mitigation rate (i e , impact fee) in effect on the date the development's application is deemed complete

I Mitigation for Impacts on Safety The CITY may request mitigation for impacts on the safety of CITY streets from any COUNTY DEVELOPMENT which impacts a documented safety problem location with three (3) or more PM peak hour trips

199907020618

- J Mitigation for Impacts on Access and Circulation The CITY may request that COUNTY DEVELOPMENTS make access and/or circulation provisions for future CITY streets to be located in the Marysville Urban Growth Area including, but not limited to provisions for connections to existing streets in corridors identified on the CITY's adopted map attached as Exhibit 4 (City of Marysville's Local Street Map of Conceptual Linkages and Approximate Corridors for the UGA). These requested provisions may include, but are not limited to, dedication of right-of-way, reservation of right-of-way, design for a potential way of access, recording of easements, location of public streets or roads, design and construction of public streets or roads (including stub roads), and improvements to existing streets or roads. All requests must be consistent with the mitigation policies identified in Section V of this AGREEMENT
- K Mitigation for Impacts on Level of Service COUNTY DEVELOPMENTS which generate more than 50 PM peak-hour trips may be required to conduct traffic studies to determine their impacts on the level-of-service (LOS) of CITY streets. The CITY may request mitigation for impacts on the LOS of the CITY street system from any such COUNTY DEVELOPMENT that causes a LOS deficiency, or that impacts a current or future LOS deficiency with three or more PM peak-hour trips. For the purposes of this AGREEMENT, a future LOS deficiency means that a level of service deficiency is forecast to occur at the time of or prior to the development's certificate of occupancy. No mitigation will be requested if the CITY's current six-year transportation improvement program (TIP) identifies improvements which will remedy the forecast LOS deficiency
- L The CITY shall make recommendations to the COUNTY regarding application of its designated mitigation policies to COUNTY DEVELOPMENTS which impact the CITY's transportation system in a manner consistent with the CITY's application of mitigation policies to CITY DEVELOPMENTS which impact the CITY's transportation system
- M Consistent with SCC 26B 55 080(2), COUNTY staff shall recommend imposing the mitigating measures requested by the CITY in accordance with this AGREEMENT as a condition of the COUNTY's development approval to the extent that such requirements are reasonably related to the impact of the development and consistent with the terms of this AGREEMENT. The approving authority for the COUNTY will impose such mitigating measures as a condition of approval of the development in conformance with the terms of this AGREEMENT unless such action would not comply with existing laws or statutes. If the SnoCoDPW determines that it may not recommend imposing the mitigating measures requested by the CITY, the SnoCoDPW will notify the CITY as soon as possible, and work with the CITY to mutually resolve any differences prior to development approval

199907020618

N The CITY shall be responsible for individualized analysis, documentation, hearing testimony, and legal review (including the private property protection process of RCW 36 70A 370) of any recommendation made by the CITY for imposition of mitigation measures on COUNTY development. The CITY shall provide all supporting documentation to the COUNTY for inclusion in the record for the COUNTY DEVELOPMENT. The CITY shall be responsible for all accounting, administration and compliance with Chapter 82 02 RCW related to mitigation by COUNTY DEVELOPMENTS for impacts in the CITY.

O Administrative Provisions for Mitigating Measures

- 1 The time of construction and/or payment to mitigate impacts in the CITY shall be in accordance with SCC 26B 55 080
- 2 Any proportionate share impact mitigation payment or construction of improvements to be made in accordance with this AGREEMENT shall be the subject of a voluntary agreement between the developer and the CITY
- 3 The requirements of SCC 26B 55 010(1),(2),(3),(4) and (7) shall apply in the determination of developer obligations. These provisions address time of determination, developer proposal of mitigation, validity of mitigating measures imposed, reinvestigation of traffic impacts and requests to amend a proposed development

IV. MITIGATION FOR IMPACTS IN THE COUNTY BY DEVELOPMENTS IN THE CITY

- A Transportation Service Areas (TSAs) and Urban Growth Areas (UGAs) For purposes of this AGREEMENT, the COUNTY shall determine the transportation impacts of CITY developments on the COUNTY road system in TSA A as shown on the TSA Map in the Snohomish County Transportation Needs Report referenced in Section VI below. It is recognized that all developments within the CITY are located inside the Urban Growth Area (UGA) as established in the Snohomish County GMA Comprehensive Plan referenced in Section VI below
- B Role of Chapter 43 21C RCW (SEPA) For most CITY developments, compliance with this AGREEMENT will satisfy the requirements to mitigate adverse and significant adverse impacts under Chapter 43 21C RCW (SEPA) for impacts on COUNTY roads. However, This AGREEMENT does not limit the ability of the COUNTY to request additional mitigation pursuant to Chapter

43 21C RCW (SEPA) where the specific impacts of the development are not addressed by this AGREEMENT or for developments with impacts outside of TSA A

C Applicability to CITY Developments This AGREEMENT applies to all developments located in the CITY which are not exempt from the requirements of SEPA, and which have submitted a complete application, as determined by the CITY on or after the effective date of this AGREEMENT For the purpose of this AGREEMENT, developments meeting these conditions will be referred hereinafter as "CITY DEVELOPMENTS "

D Providing Notice The CITY shall give the COUNTY agency notice and afford the COUNTY a timely opportunity for review, comment, staff consultation, and, where applicable, participation in the CITY's development review and approval process, related to the impacts that a CITY DEVELOPMENT may have on the COUNTY's transportation system under the COUNTY's designated mitigation policies

1 For all CITY DEVELOPMENTS, the CITY shall provide timely notice of application to the COUNTY. Notice shall be accompanied by a traffic study, when determined necessary in accordance with Section IV(E)

2 In addition, notice to the COUNTY shall be provided in a form and manner pursuant to the State Environmental Policy Act (SEPA), Chapter 43 21C RCW, for agencies with jurisdiction

E Traffic Study The CITY, through this AGREEMENT, shall require a traffic study from any CITY DEVELOPMENT that may have impacts on the COUNTY's transportation system requiring mitigation in accordance with this AGREEMENT Any such CITY DEVELOPMENT shall submit the requested traffic study to the CITY as part of its initial development application

1 The criteria for preparation of the traffic study shall be provided by the COUNTY and shall be consistent with Exhibit 3 for traffic studies to determine proportionate share impact mitigation

2 The CITY may waive the requirement for all or part of the traffic study if the COUNTY indicates that all information necessary to assess the impact of the development is available

3 The CITY shall inform applicants, at the pre-application stage, of the COUNTY's requirements for traffic studies and mitigation

4 Following review of the traffic study, the COUNTY may request supplemental information and analysis as necessary to determine the impacts of the development in accordance with this AGREEMENT. The CITY shall require the proposed development to submit the supplemental information and analysis to the extent that the CITY determines that it is necessary to determine the impacts of the development in accordance with this AGREEMENT.

F **Mitigating Measures** If it is determined by the COUNTY that a CITY DEVELOPMENT will impact the COUNTY's transportation system, the COUNTY shall notify the CITY of specific measures reasonably necessary to mitigate said impacts in accordance with the COUNTY's designated mitigation policies referenced in Section VI. For each mitigating measure requested the COUNTY shall identify the specific impact and reference the relevant COUNTY mitigation policy. Notification of the specific mitigating measures shall be provided by the COUNTY within twenty-one (21) days of the date of notice of application provided in accordance with Section IV(D), except where notice is for review of an environmental impact statement, in which case the review period shall be as established in accordance with WAC 197-11-502.

If the CITY does not receive the COUNTY's notification of mitigating measures consistent with Section IV(F) above, the CITY may assume that the COUNTY has no comments or information relating to potential impacts of the development on COUNTY facilities and may not require any mitigation from the development for impacts on COUNTY facilities. The provisions of this section do not apply if the CITY fails to provide the COUNTY with notice of the development consistent with Section IV(D) above.

G **Scope of Mitigating measures** Under this AGREEMENT, CITY DEVELOPMENTS may be required to mitigate impacts on COUNTY roads for any of the following: capacity (proportionate share impact mitigation), safety, access and circulation, or level of service.

H **Proportionate Share Impact Mitigation for CITY DEVELOPMENTS** The COUNTY may request that a CITY DEVELOPMENT contribute a proportionate share of programmed capacity improvements to mitigate capacity impacts on COUNTY roads. There are two options for determining a CITY DEVELOPMENT's proportionate share impact mitigation as follows:

1 The COUNTY has adopted a list of capacity improvements on COUNTY roads which is contained in Appendix D of the Snohomish County Transportation Needs Report (TNR). The improvements are needed to support growth in Snohomish County consistent with the COUNTY GMA comprehensive plan. Based on a comprehensive traffic study, a

development's proportionate share impact mitigation may be calculated by determining the development's impact on these planned improvements and may be satisfied by payment in lieu of construction. In determining the proportionate share payment under this option, the traffic study must meet the requirements shown in Exhibit 3.

2 Alternatively, a CITY DEVELOPMENT may choose to have its proportionate share impact mitigation based on an amount determined by the COUNTY and the CITY to fairly represent the average impacts of CITY DEVELOPMENTS on the capacity of COUNTY facilities for different subareas within the CITY as described in Exhibit 2. Any development may satisfy its obligations under this section to contribute a proportionate share of CITY capacity improvements, by making a voluntarily-offered payment in lieu of construction equal to the percentage determined for the appropriate subarea as shown in the table in Exhibit 2, multiplied by the development's newly-generated average daily trips, multiplied by the COUNTY's capacity mitigation rate (i.e., impact fee) in effect on the date the development's application is deemed complete.

- I Mitigation for Impacts on Safety. The COUNTY may request mitigation for impacts on the safety of roads from any CITY DEVELOPMENT which impacts a COUNTY Inadequate Road Condition with three or more PM peak hour trips as provided in SCC 26B 55 040.
- J Mitigation for Impacts on Access and Circulation. The COUNTY may request that CITY DEVELOPMENTS make access and/or circulation provisions for existing or future arterials that are located in the CITY including, but not limited to provisions for connections to existing roads in corridors identified on the COUNTY's adopted Arterial Circulation Plan map. These requested provisions may include, but are not limited to, dedication of right-of-way, reservation of right-of-way, design for a potential way of access, recording of easements, location of public streets or roads, design and construction of public streets or roads (including stub roads), and improvements to existing streets or roads. All requests must be consistent with the mitigation policies identified in Section VI of this AGREEMENT.
- K Mitigation for Impacts on Level of Service. CITY DEVELOPMENTS which generate more than 50 PM peak-hour trips may be required to conduct traffic studies to determine their impacts on the level of service (LOS) of COUNTY roads. The COUNTY may request mitigation for impacts on the LOS of the COUNTY road system from any such CITY DEVELOPMENT that causes an

arterial unit in arrears, as defined in SCC 26B 51 005, or that impacts a current or future arterial unit in arrears with three or more PM peak-hour trips For the purposes of this AGREEMENT, a future arterial unit in arrears means that a level of service deficiency is forecast to occur on an arterial unit at the time of or prior to the development's certificate of occupancy and that the COUNTY's current six-year transportation improvement program (TIP) does not identify improvements which will remedy the forecast LOS deficiency on the arterial unit

- L The COUNTY shall make recommendations to the CITY regarding application of its designated mitigation policies to CITY DEVELOPMENTS which impact the COUNTY's transportation system in a manner consistent with the COUNTY's application of mitigation policies to COUNTY DEVELOPMENTS which impact the COUNTY's transportation system
- M The CITY shall recommend imposing the mitigating measures requested by the COUNTY in accordance with this AGREEMENT as a condition of the CITY's development approval to the extent that such requirements are reasonably related to the impact of the development and consistent with the terms of this AGREEMENT The approving authority for the CITY will impose such mitigating measures as a condition of approval of the development in conformance with the terms of this AGREEMENT unless such action would not comply with existing laws or statutes If the CITY determines that it may not recommend imposing the mitigating measures requested by the COUNTY, then the CITY will notify the COUNTY as soon as possible, and work with the COUNTY to mutually resolve any differences prior to development approval
- N The COUNTY shall be responsible for individualized analysis, documentation, hearing testimony, and legal review (including the private property protection process of RCW 36 70A 370) of any recommendation made by the COUNTY for imposition of mitigation measures on CITY development The COUNTY shall provide all supporting documentation to the CITY for inclusion in the record for the CITY DEVELOPMENT The COUNTY shall be responsible for all accounting, administration and compliance with Chapter 82 02 RCW related to mitigation by CITY DEVELOPMENTS for impacts in the COUNTY
- O Administrative Provisions for Mitigating Measures
 - 1 The time of construction and/or payment of mitigating measures shall be as follows
 - a) For plats, prior to or at the time of recording

b) For all other developments prior to issuance of permits

2 Any proportionate share impact mitigation payment or construction of improvements to be made in accordance with this AGREEMENT shall be the subject of a voluntary agreement between the developer and the COUNTY

V. COUNTY RECOGNITION OF CITY'S DESIGNATED REGULATIONS, PLANS, CODES AND MITIGATION POLICIES FOR PURPOSES OF SEPA REVIEW AND/OR DEVELOPMENT REVIEW

This AGREEMENT addresses the procedures for identification, documentation, and mitigation of interjurisdictional traffic impacts. The COUNTY recognizes the following designated mitigation policies of the CITY as a basis for the COUNTY's exercise of review and mitigation authority pursuant to state and local law

- 1 Chapter 18 24 MMC, Mitigation of Impacts Resulting from Development Proposals, as now existing or hereafter amended
- 2 Chapter 19 22 MMC, Procedures and Policies Implementing the State Environmental Policy Act, as now existing or hereafter amended
- 3 The *City of Marysville Comprehensive Plan* adopted by Ordinance 2068 including, but not limited to, the Capital Facilities Element, the Transportation Element, and the Streetscape Element, as now existing or hereafter amended
- 4 City of Marysville's Local Street Map of Conceptual Linkages and Approximate Corridors for the UGA
- 5 CITY codes, chapters, resolutions, plans or reports incorporated by reference in titles, chapters, documents, or plans cited above

VI. CITY RECOGNITION OF COUNTY'S DESIGNATED REGULATIONS, PLANS, CODES, AND MITIGATION POLICIES FOR PURPOSES OF SEPA REVIEW AND/OR DEVELOPMENT REVIEW

This AGREEMENT addresses the procedures for identification, documentation, and mitigation of interjurisdictional traffic impacts. The CITY recognizes the following designated mitigation policies of the COUNTY as a basis for the CITY's exercise of review and mitigation authority pursuant to state and local law.

- A. The COUNTY's Environmental Policy Ordinances, Title 23 SCC, and the COUNTY's adopted policies for the substantive authority of SEPA as identified in SCC 23 36-030, including, but not limited to
 - 1. Title 26B SCC as now existing or hereafter amended, and
 - 2. The Snohomish County GMA Comprehensive Plan adopted by Ordinance 94-125 in June 1995 including, but not limited to, the General Policy Plan, Capital Facilities Element and the Transportation Element, as now existing or hereafter amended.
- B. COUNTY codes, chapters, resolutions, plans or reports incorporated by reference in titles, chapters, documents, or plans cited above, including, but not limited to
 - 1. Snohomish County's Engineering Design and Development Standards (EDDS) adopted under Chapter 13 05 SCC, as now existing or hereafter amended, and
 - 2. The Snohomish County Transportation Needs Report, as now existing or hereafter modified.

VII. RELATIONSHIP TO EXISTING LAWS AND STATUTES

This AGREEMENT in no way modifies or supersedes existing laws and statutes. In meeting the commitments encompassed in this AGREEMENT, all parties shall comply with the requirements of the Open Meetings Act, Growth Management Act, State Environmental Policy Act, Annexation Statutes and other applicable State or local law. The ultimate authority for land use and development decisions is retained by the COUNTY and CITY within their respective jurisdictions. By executing this AGREEMENT, the COUNTY and CITY do not purport to abrogate the decision-making responsibility vested in them by law.

VIII. RELATIONSHIP TO FUTURE PLANNING AND RECIPROCAL IMPACT MITIGATION AGREEMENTS

The CITY and COUNTY understand that many multi-jurisdictional planning and growth management issues will need to be addressed as growth continues. Both parties also understand that joint planning agreements will be required to accomplish the planning and plan implementation requirements of the Growth Management Act of 1990 as amended. Such agreements may focus on particular issues and delineate specific responsibilities that are beyond the scope of this AGREEMENT.

IX. DEVELOPMENT AND REVIEW OF ENVIRONMENTAL STANDARDS

The COUNTY and the CITY will continue to work toward the establishment of coordinated transportation system development standards and development mitigation policies. The COUNTY and the CITY will periodically review their existing mitigation policies for consistency in the implementation of this AGREEMENT, and will promptly notify the other in the event of any material change in such policies. In that event, the parties agree to amend this AGREEMENT as appropriate.

X. EFFECTIVE DATE, DURATION, MODIFICATION AND TERMINATION

- A This AGREEMENT shall become effective following the approval of the AGREEMENT by the official action of the governing bodies of each of the parties hereto and the signing of the AGREEMENT by the duly authorized representative of each of the parties hereto.
- B This AGREEMENT may be modified or terminated upon mutual agreement of the parties. Any modification shall become effective 30 days following written amendment to the AGREEMENT executed by both parties. Any mutual termination shall become effective 90 days following written amendment to the AGREEMENT executed by both parties. Any amendments and termination shall be in writing and executed in the same manner as provided by law for the execution of this AGREEMENT.

C Either party may terminate its obligations under this AGREEMENT upon 180 days advance written notice to the other party and under the following conditions. The party seeking the unilateral termination, the "aggrieved party," shall agree to professional mediation with the other party if so requested. The other party must make its request in writing within 60 days of receipt of the written notice from the aggrieved party. Under this AGREEMENT both parties agree to share equally in the expense of mediation in such cases.

D Following any amendment or termination, the COUNTY and CITY are mutually responsible for fulfilling any outstanding obligations under this AGREEMENT incurred prior to the effective date of the amendment or termination. The COUNTY and CITY agree to follow the terms of this AGREEMENT for any developments submitted prior to the effective date of the amendment or termination.

XI. INDEMNIFICATION AND LIABILITY

- A The CITY shall protect, save harmless, indemnify, and defend, at its own expense, the COUNTY, its elected and appointed officials, officers, employees and agents, from any loss or claim for damages of any nature whatsoever, arising out of the CITY's performance of this AGREEMENT, including claims by the CITY's employees or third parties, except for those damages solely caused by the negligence or willful misconduct of the COUNTY, its elected and appointed officials, officers, employees or agents.
- B The COUNTY shall protect, save harmless, indemnify, and defend, at its own expense the CITY, its elected and appointed officials, officers, employees and agents from any loss or claim for damages of any nature whatsoever, arising out of the COUNTY's performance of this AGREEMENT, including claims by the COUNTY's employees or third parties, except for those damages solely caused by the negligence or willful misconduct of the CITY, its elected and appointed officials, officers, employees or agents.
- C In the event of liability for damages of any nature whatsoever arising out of the performance of this AGREEMENT by the CITY and the COUNTY, including claims by the CITY's or the COUNTY's own officers, officials, employees, agents, volunteers, or third parties, caused by or resulting from the concurrent negligence of the COUNTY and the CITY, their officers, officials, employees and volunteers, each party's liability hereunder shall only be to the extent of that party's negligence.

D No liability shall be attached to the CITY or the COUNTY by reason of entering into this AGREEMENT except as expressly provided herein. The CITY shall hold the COUNTY harmless and defend at its expense any legal challenges to the CITY's requested mitigation and/or any failure by the CITY to comply with RCW 82.02.020 or RCW 82.02.070.

XII. COMPLIANCE WITH THE LAW

The COUNTY and the CITY shall comply with all applicable federal, state and local laws in performing this AGREEMENT.

XIII. EXERCISE OF RIGHTS OR REMEDIES

Failure of either party to exercise any rights or remedies under this AGREEMENT shall not be a waiver of any obligation by either party and shall not prevent either party from pursuing that right at any future time.

XIV. RECORDS

Both parties shall maintain adequate record to document obligations performed under this AGREEMENT. Both parties shall have the right to review the other party's records with regard to the subject matter of this AGREEMENT, upon reasonable notice. Such rights last for six (6) years from the date of permit issuance for each specific development subject to this AGREEMENT.

XV. SEVERABILITY

Should any clause, phrase, sentence or paragraph of this AGREEMENT or its application be declared invalid or void by a court of competent jurisdiction, the remaining provisions of this AGREEMENT or its application of those provisions not so declared shall remain in full force and effect.

XVI. ENTIRE AGREEMENT

This AGREEMENT constitutes the entire agreement between the parties with respect to the reciprocal mitigation of traffic impacts.

XVII. GOVERNING LAW AND STIPULATION OF VENUE

This AGREEMENT shall be governed by the laws of the State of Washington
Any action hereunder must be brought in the Superior Court of Washington for
Snohomish County

XVIII. CONTACTS FOR AGREEMENT

The contact persons for this AGREEMENT are

Gloria Hirashima
Planning Director
City of Marysville
80 Columbia Avenue
Marysville, WA 98270
(360) 651-5100

John Davis
Transportation Specialist
Snohomish County Public Works
2930 Wetmore AV
Everett, WA 98201
(425) 388-3488

IN WITNESS WHEREOF, the parties have signed this AGREEMENT, effective on the
date indicated below

Dated this 1st day of July, 1999.

CITY OF MARYSVILLE

BY

David Weiser

Mayor

ATTEST

Lillem Lee

City Clerk **DEPUTY**

Approved as to form
Office of the City Attorney

Grant K. Weel

City Attorney
Marysville

SNOHOMISH COUNTY

BY

Robert J. Drewel
County Executive

GARY WEIKEL
Executive Director

ATTEST

Sheila McCallister

7-1-99
Clerk of the County Council

Approved as to form
Snohomish County Prosecutor

Barbara Dykes 6/11/99

Barbara Dykes
Deputy Prosecuting Attorney (Civil)
Snohomish County

Exhibit 1

Estimated Percentage of Trips from County Developments Impacting City Streets

Sub-Area ID#	**County Sub-Area Description	Residential Developments	Commercial Developments
CO-MA1	West of I-5, north of the east-west line that runs between Sections 29 and 32 of Township 31 North, Range 5 East, south of 188th ST NW, east of 40th AV NW/ E Lake Goodwin Road/ 46th AV NW	25%	25%
CO-MA2	West of I-5 and south of the east-west line that runs between Sections 29 and 32 of Township 31 North, Range 5 East	30%	30%
CO-MA3	East of I-5, north of the east-west line that runs between Township 30 North and Township 31 North, and south of SR 531	25%	25%
CO-MA4	East of I-5 and south of the east-west line that runs between Township 30 North and Township 31 North AND outside the Marysville urban growth area	40%	40%
CO-MA5	East of I-5 and south of the east-west line that runs between Township 30 North and Township 31 North AND inside the Marysville urban growth area	80%	80%

Note: All subareas are within the County Transportation Service Area (TSA) A

Exhibit 1a

Map of County Subareas

Note: The subarea descriptions will be used in cases in which the map is vague or incorrect.

199907020618

Exhibit 2

Estimated Percentage of Trips from City Developments Impacting County Roads

Sub-Area ID #	* City Subarea Description	Residential Developments	Commercial Developments
CI-MA-1	North of 136th ST SE	20%	20%
CI-MA-2	North of 100th ST NE and South of 136th ST SE	20%	20%
CI-MA-3	North of 76th ST NE, South of 100th ST SE, and West of 51st AV NE	25%	25%
CI-MA-4	North of 76th ST NE, South of 100th ST SE, and East of 51st AV NE	30%	30%
CI-MA-5	South of 76th ST NE	15%	10%

* Note Boundaries are either street centerlines or imaginary extensions of street centerlines in places where the actual streets do not exist

199907020618

Exhibit 2a

Map of City Subareas

Note: The subarea descriptions will be used in cases in which the map is vague or incorrect

199907020618

Exhibit 3 General Requirements for Traffic Studies to Determine Proportionate Share Impact Mitigation

- A Transportation Facilities As used in this context refers to any transportation facilities which have been identified in a Transportation Element or Six-Year Transportation Improvement Program (TIP) as needing capacity improvements to support planned development
- B Impacted Transportation Facilities Determine which of the transportation facilities are impacted by development-generated PM peak hour trips (PM PHT)
- C Current Counts For each impacted transportation facility, conduct traffic counts to determine the current PM PHT
- D Reserve Capacity Determine "reserve capacity" for each impacted transportation facility by subtracting the current PM PHT from the maximum capacity for the existing transportation facility Reserve capacity is set to zero if current PM PHT exceeds the current capacity
- E New Capacity New capacity is the incremental increase in PHT that will result from the planned improvement to the transportation facility Determine the new capacity of each impacted transportation facility by subtracting the current capacity from the future capacity after the improvement
- F Chargeable Capacity For each impacted road section, add the reserve capacity to the new capacity
- G Capacity Cost per Peak-Hour Trip For each impacted road section, determine the capacity cost per PM PHT by dividing the adjusted project cost by the chargeable capacity
- H Development's Trip Generation and Distribution Determine the PM peak-hour trip generation and distribution for the development at build out
- I Traffic Impacts Determine the number of PM PHT impacting each transportation facility
- J Proportionate Share For each impacted transportation facility, determine the proportionate share impact mitigation by multiplying the capacity cost per peak-hour trip by the number of PM PHT impacting the transportation facility

199907020618

Exhibit 4
City of Marysville
Local Street Map of
Conceptual Linkages and
Approximate Corridors
for the UGA

LEGEND

- Existing Arterials
- Conceptual Linkages and Approximate Corridors
- Parcels

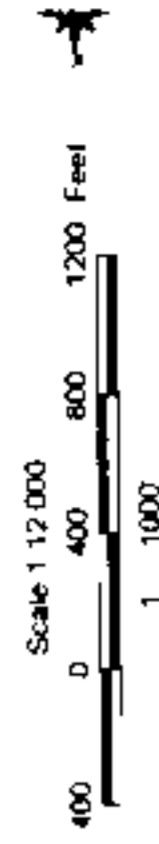

Sunnyside Study Area

Connecting Links

- 1 76th Ave. to 87th Ave. NE
- 2 W and 92nd to Sunnyside Blvd
- 3 Sunnyside Blvd at 49th St NE
- 4 72nd Dr NE to 44th St NE via 46th Pl NE
- 5 Connects link 1 to 44th St NE via existing 79th Ave NE
- 6 Connects existing 79th Ave NE to SR9
- 7 Connects links 2 & 13 to Sunnyside Blvd
- 8 Connect Sunnyside Blvd to 40th St NE
- 9 Connects S end of 67th Ave (at intersection of 44th) to Soper Hill Rd
- 10 Connects 40th St NE to 71st Ave
- 11 Connects 71st to link 19
- 12 Connects 79th Ave to 87th Ave NE
- 13 Connects link 2 & 7 to Sunnyside Blvd at link 4
- 14 Connects Sunnyside Blvd to link 9
- 15 Connects link 14 at link 9 to 71st Ave
- 16 Connects 71st Ave NE to link 11
- 17 Connects 79th Ave NE to link 11
- 18 Connects Sunnyside to link 14
- 19 Connects link 20 to 79th Ave NE
- 20 Connects 71st Ave NE to 87th Ave NE

Approximate Corridor

- East/west between 54th & 55th St NE
- North/south between 58th & 60th Ave NE
- North/south between 63rd & 64th Ave NE
- North/south between 72nd & 76th Ave NE
- North/south between 76th & 80th Ave NE
- East/west between 49th & 51st St NE
- East/west between 39th & 41st St NE
- North/south 63rd & 65th St NE
- North/south 66th & 68th Ave NE
- North/south between 68th & 71st Ave NE
- East/west between 35th & 37th St NE
- East/west between 59th & 62nd Ave NE
- East/west between 36th & 37th Ave NE
- East/west between 36th & 37th St NE
- East/west between 35th & 37th St NE
- East/west between 32nd & 33rd St NE
- North/south between 15th & 19th Ave NE
- East/west between 32nd & 34th Ave NE

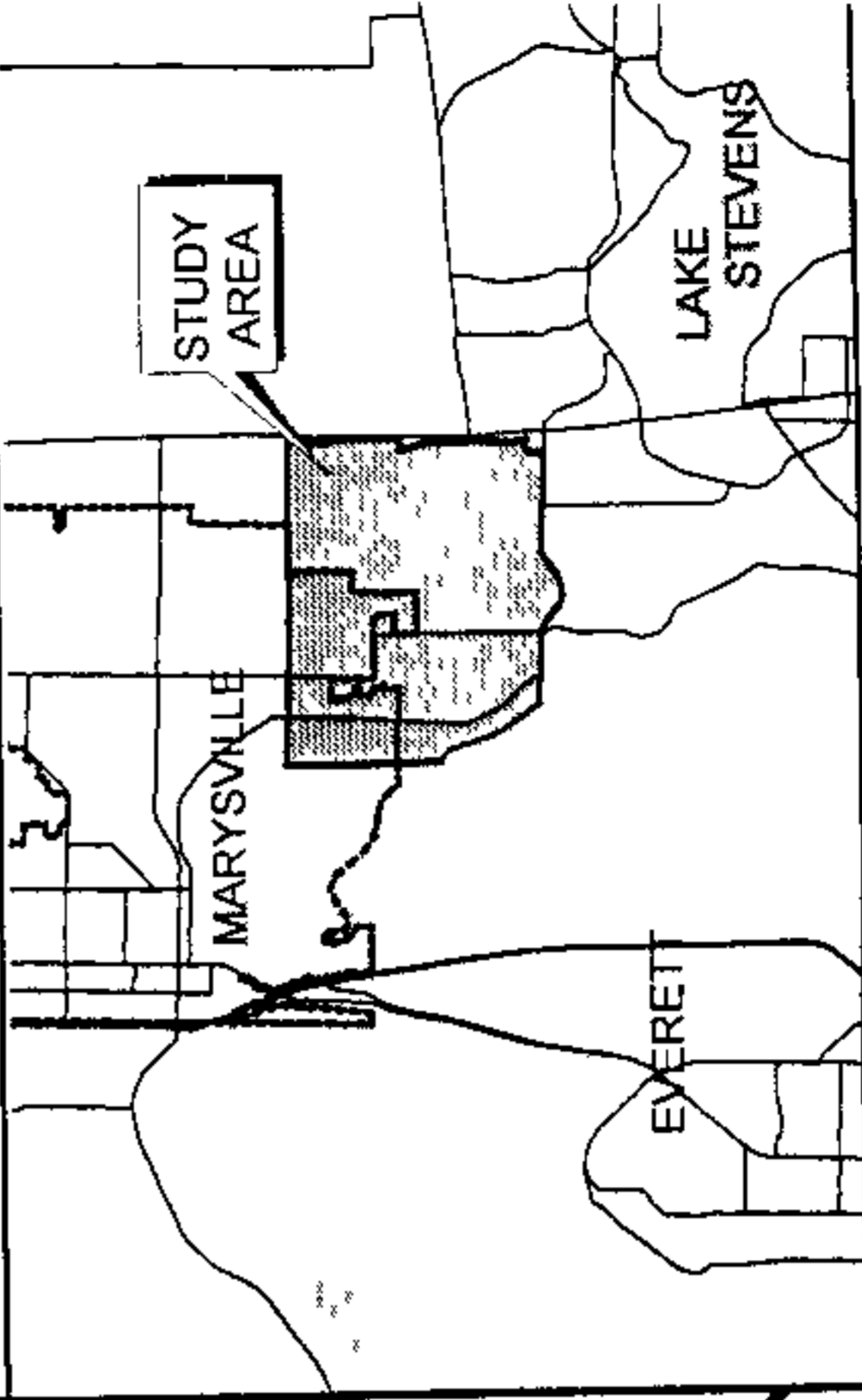
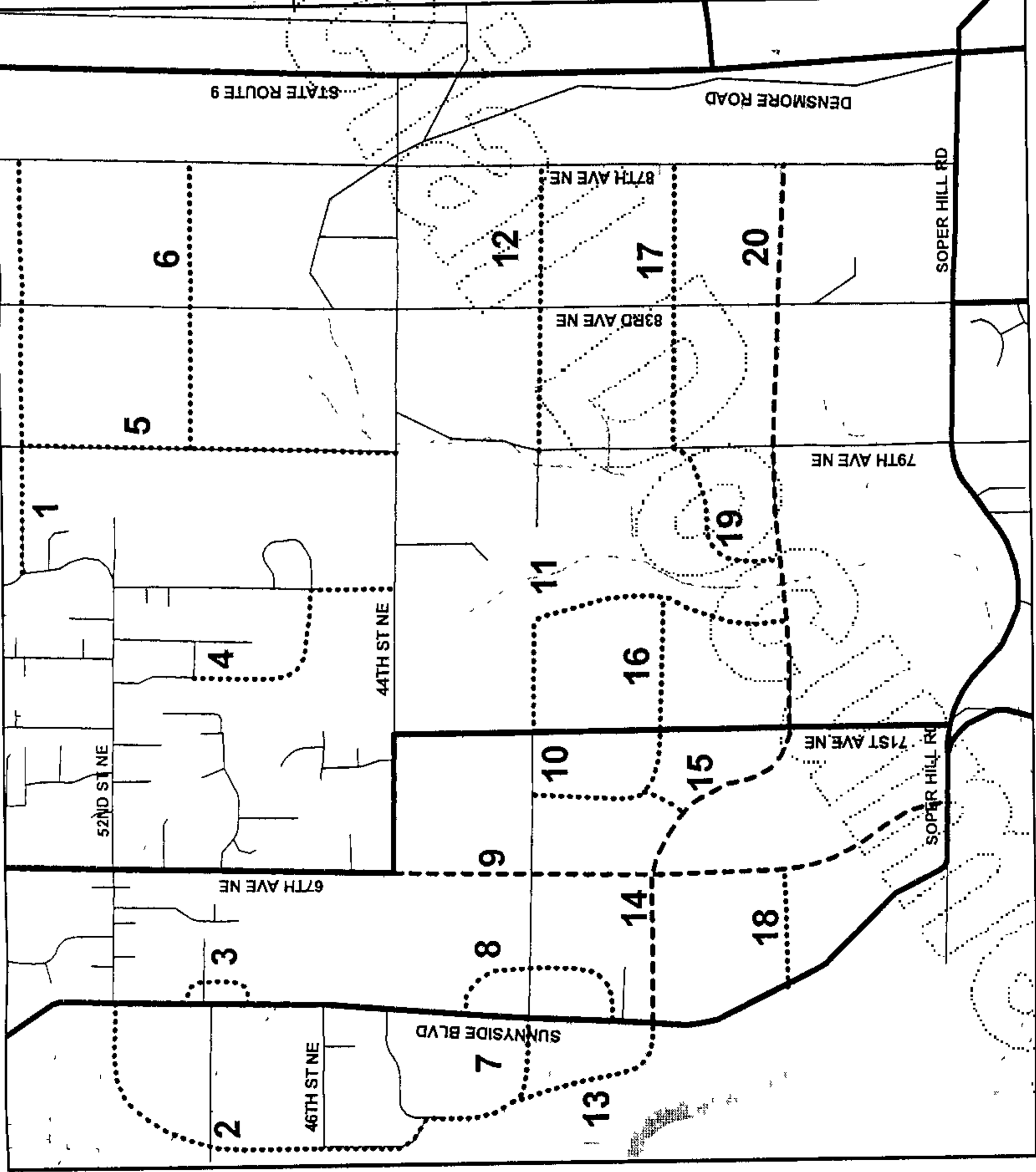

DRAFT