

NOTES:

1. TILE FOR SHOWER TO EXTEND 10" ABOVE DRAIN INLET WITH WATER RESISTANT BACKING.
2. DISHWASHER TO HAVE AIR GAP
3. SHOWER HEADS SHALL BE EQUIPPED WITH FLOW CONTROL DEVICES TO LIMIT FLOW TO A MAX OF 3 GPM PER SHOWER HEAD.
4. SAFETY GLASS IS REQUIRED ON SHOWER DOORS.
5. HOT WATER TANK PROVIDE PRESSURE RELIEF VALVE PIPE. DRAIN TO OUTSIDE. DRAIN PIPE TO EXTEND WITHIN 2" ABOVE GROUND POINTING DOWN. NO TRAPPING. UPC 608.5.
6. DRYER TO BE SEPARATELY VENTED TO OUTSIDE.
7. ATTIC ACCESS TO BE READILY ACCESSIBLE. MINIMUM SIZE 22"x30" WITH 30" UNOBSTRUCTED HEADROOM. R00T.1
8. SEE SECTION R001.10 FOR HEARTH REQUIREMENTS ON EACH SIDE OF OPENING AND IN FRONT OF FIREBOX.
9. FURNACE INSTALLED IN GARAGE APPLY G.M.B. AND FIRE-TAPE ABOVE AND BEHIND FURNACE PRIOR TO INSTALLATION.
10. HANDRAILS SHALL BE PROVIDED ON TWO SIDE OPEN AND CONTINUOUS ON ONE SIDE ONLY. HANDRAIL SHALL BE 34"-38" ABOVE NOSING OF TREAD AND SHALL BE CONTINUOUS THE FULL LENGTH OF THE STAIRS AND THE ENDS SHALL RETURN TO

THE WALL OR SHALL TERMINATE IN A NEWELL POST. THERE SHALL BE NOT LESS THAN 1-1/4" NOR MORE THAN 2" IN CROSS SECTIONAL DIMENSION, AND SHALL HAVE A SMOOTH SURFACE WITH NO SHARP CORNERS.

II. APPLIANCES INSTALLED IN GARAGE SHALL BE LOCATED OUT OF THE NORMAL PATH OF VEHICLES OR A MEANS OF PROTECTION SHALL BE PROVIDED. UNITS GENERATING A SPARK OF FLAME SHALL HAVE PILOTS AND BURNERS 18" ABOVE THE FLOOR.

12. ALL ELECTRIC WATER HEATERS IN UNHEATED SPACES SHALL BE PLACED ON AN UNCOMPRESSIBLE INSULATED SURFACE OF R-10. MEEG 2006.

13. HOSE BIBS REQUIRED TO HAVE AN APPROVED BACKFLOW PREVENTION.

14. USABLE SPACE UNDER STAIRS, WALLS AND CEILING TO HAVE 1/2" TYPE X G.M.B. SEC. 1003.5.3.9.

15. FIREBLOCK STAIRWAYS BETWEEN STRINGERS AND RUN DOWN STUDS.

16. MAXIMUM RISE 7-3/4" MINIMUM RUN 10" MINIMUM WIDTH 36" MINIMUM HEADROOM 6'-8".

17. HANDRAIL TO BE MINIMUM 34"-38" WITH BALUSTERS NOT TO ALLOW A 4" SPHERE TO PASS THROUGH.

WALL BRACING PANEL SCHEDULE

| | | |
|---|---|--|
| A | PLYWOOD/OSB 5/8"x4'x8' | 6d NAILS 6" OC (EDGES) 12" OC (FIELD) |
| B | GMB - 1/2"x8'x8' (ONE FACE) | 5d COOLER NAILS OR WALLBOARD NAILS 7" OC THROUGHOUT |
| C | GMB - 1/2"x4'x8' (TWO FACES) | 5d COOLER NAILS OR WALLBOARD NAILS 7" OC THROUGHOUT |
| D | STRUCTURAL PANEL SIDING 5/8"x4'x8' | CORROSION RESISTANT 6d NAILS ● 6" OC (EDGES) ● 12" OC (FIELD) |
| E | ONE-STORY ALT BRACED PANEL 5/8"x2'-8"x10" OR LESS | NAILING 8d ● 6" OC (EDGES) 8d ● 12" OC (FIELD) BLOCKING REQUIRED AT ALL EDGES 2 ANCHOR BOLTS PLACED AT QUARTER POINTS HOLDINGS - 1800# AT EACH END |
| F | TWO-STORY ALT. BRACED PANEL 5/8"x2'-8"x10" OR LESS PLYWOOD OR OSB (TWO FACES) | NAILING 8d ● 6" OC (EDGES) 8d ● 12" OC (FIELD) BLOCKING REQUIRED AT ALL EDGES 3 ANCHOR BOLTS PLACED AT FIFTH POINTS HOLDINGS - 3000# AT EACH END |

GENERAL NOTES:
BRACED WALL PANEL SOLE PLATES NAILED TO FLOOR AND TOP PLATES SHALL BE ANCHORED TO FRAMING ABOVE.
WHERE JOISTS ARE PERPENDICULAR TO BRACED WALL LINES, PROVIDE BLOCKING UNDER AND IN LINE WITH BRACED WALL PANELS.

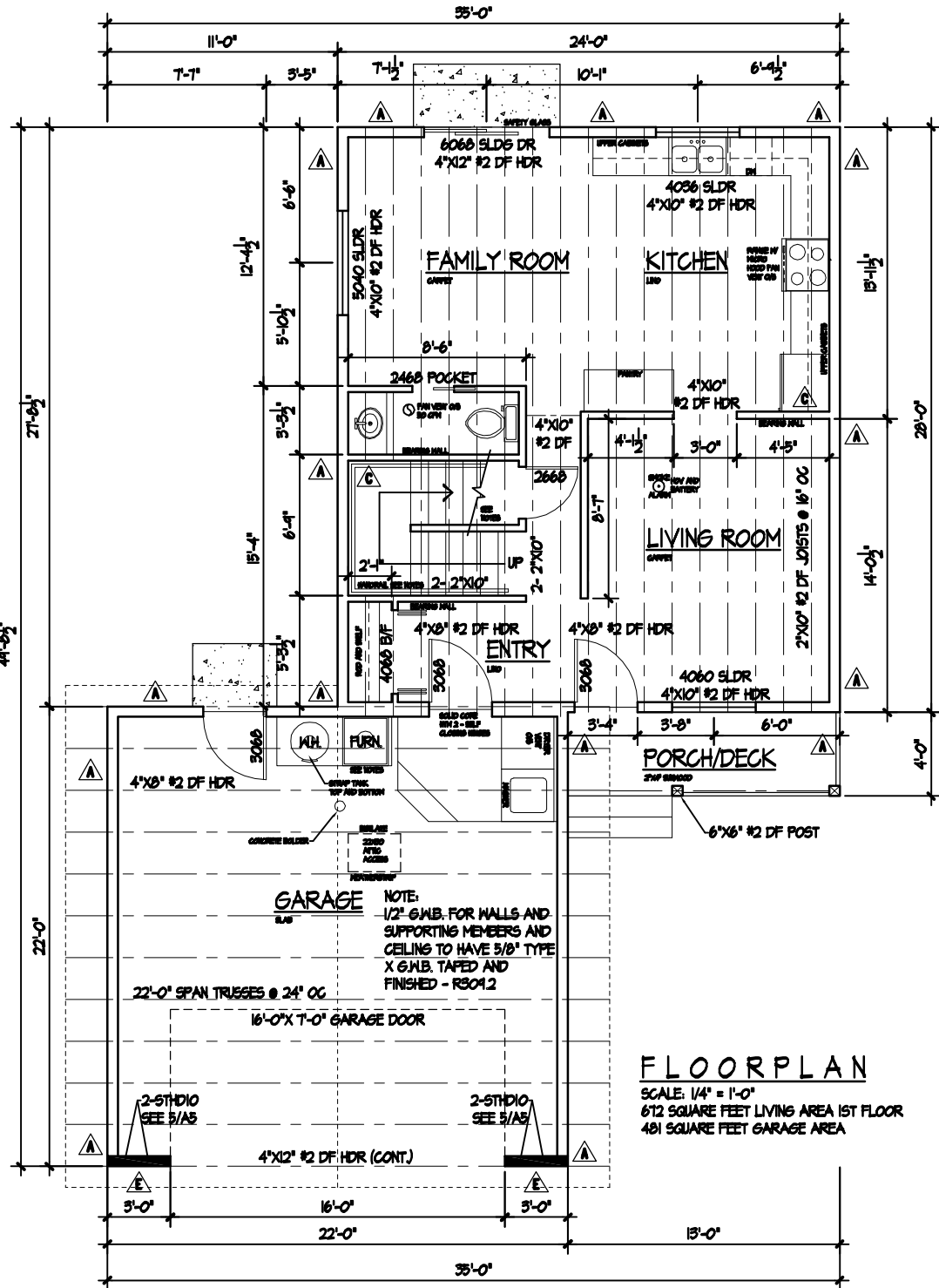

FLOOR PLAN
SCALE: 1/4" = 1'-0"
612 SQUARE FEET LIVING AREA 1ST FLOOR
481 SQUARE FEET GARAGE AREA

FOR ILLUSTRATION PURPOSES ONLY